

4

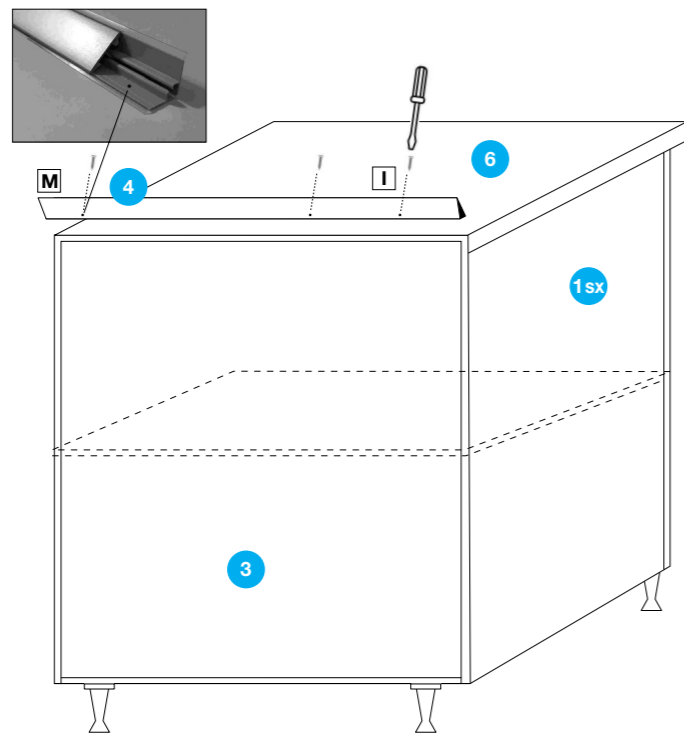

BASE 30/40/60 KIT prof. 50

BASE 30/40/60 KIT Depth 50



2 fianchi Dx-Sx
2 right-left sides

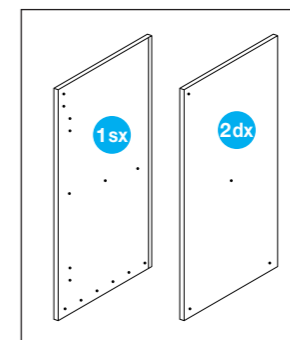

piano inferiore / downstairs

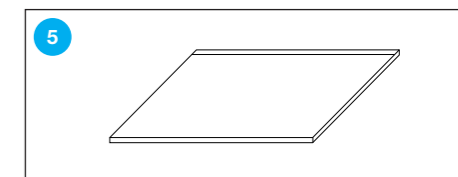

piano superiore / upper floor

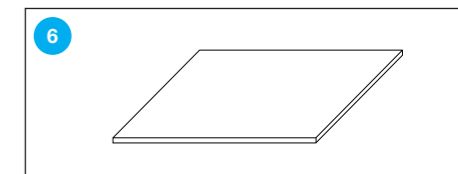

1 anta / 1 door

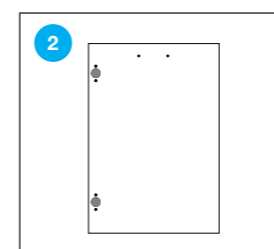

schienale / back

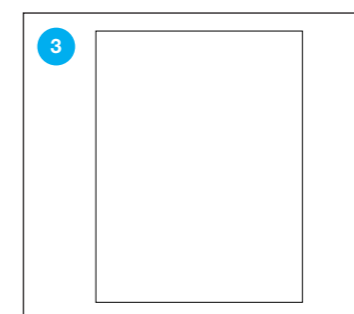

tramezzo orizzontale anteriore
front horizontal partition

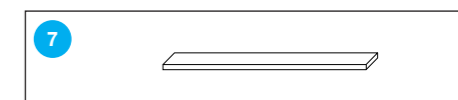

alzatina / back splash

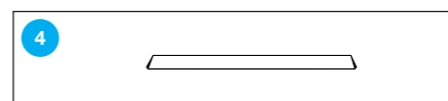

mensola interna / internal shelf

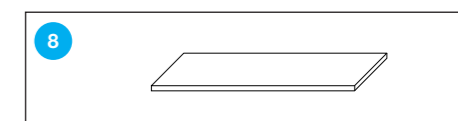

FERRAMENTA / HARDWARE



A 22 X
SPINE IN LEGNO 8X35
WOODEN LOWEL 8x35



B 8 X
VITI MONTAGGIO 7X50
TESTA ESAGONALE
7X50 HEX HEAD
MOUNTING SCREWS

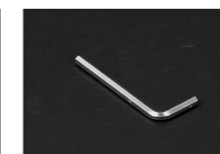

C 1 X
CHIAVINO ESAGONALE
MM. 4 ZINC.
HEX KEY MM. 4
GALVANIZED



D 1 X
MANIGLIA CON VITI
HANDLE WITH SCREWS



E 2 X
CERNIERA D.35 COLLO
DRITTO
HINGE D.35 STRAIGHT
NECK

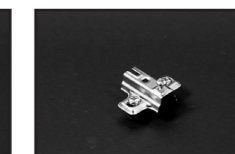

F 2 X
BASETTA A PRESSIONE
PER CERNIERA
PRESSURE BASE
FOR HINGE



G 4 X
PIEDINO IN PLASTICA
PLASTIC FOOT

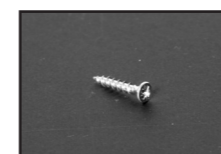

H 16 X
VITI ECL PZD TPS FT
4X20 ZINC.
SCREWS ECL PZD TPS
FT 4X20 GALVANIZED

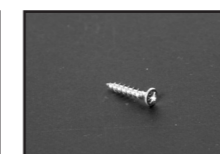

I 2 X
VITI ECL PZD TPS FT
3,5X20 ZINC.
SCREWS ECL PZD TPS FT
3,5X20 GALVANIZED



L 1 X
TUBETTO COLLA GR. 15
TUBE OF GLUE GR. 15

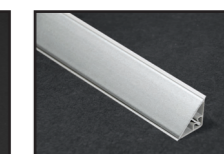

M 1 X
ALZATINA
BACK SPLASH



Istruzioni di montaggio Base 30/40/60.

- A) Per evitare graffiature, si consiglia di eseguire il montaggio della scarpiera su una base orizzontale coperta.
- B) È consigliato di eseguire il montaggio da 2 persone.

Assembly instructions Base 30/40/60.

- A) To avoid scratches, mounting is recommended of the shoe cabinet on a covered horizontal base.
- B) It is recommended to carry out the assembly by 2 people.

